

Quote   
 Order

Quoted Already?  
 Yes/No  
 Quote No: .....

**Reynaers CF68 Bi-folding Doors - Viewed From OUTSIDE**

Company .....  
 Reference .....  
 Del Date Requested .....

**External** Colour: White/Anthracite Grey/ Black  
 Special RAL Code .....  
**Internal** Colour: White/Anthracite Grey/ Black  
 Special RAL Code .....

**CONFIGURATION** .....

**OPEN IN      OPEN OUT**

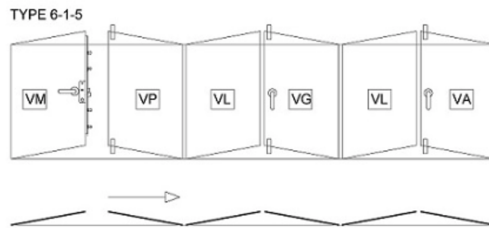
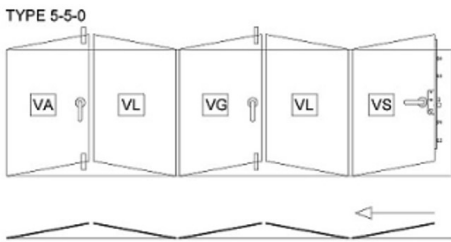
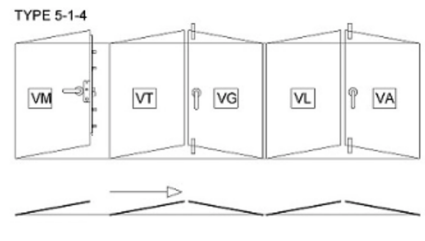
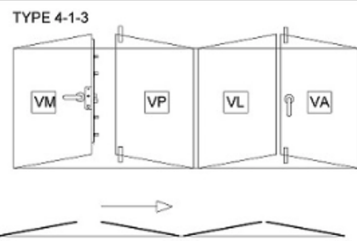
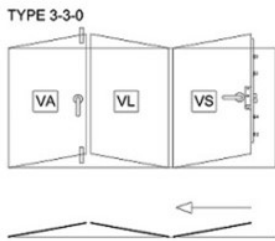

**Cill Size:**  
 95mm  
 150mm  
 180mm  
 225mm

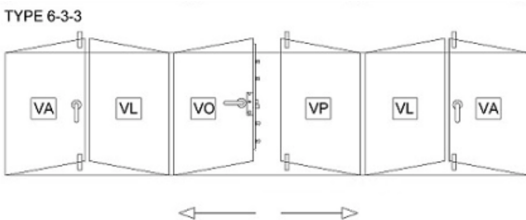

**FRAME WIDTH** .....  
**FRAME HEIGHT** .....

**KIT FORM?**  
 YES/NO

**Handle Colour:**    White    Chrome    Satin    Black    Graphite    Gold

**Rollers/Slave Handle/Pull Handle/Spring Catch:**    White    Black    Light Grey

**Glass Makeup Required** ..... **GLASS WILL BE SUPPLIED LOOSE**

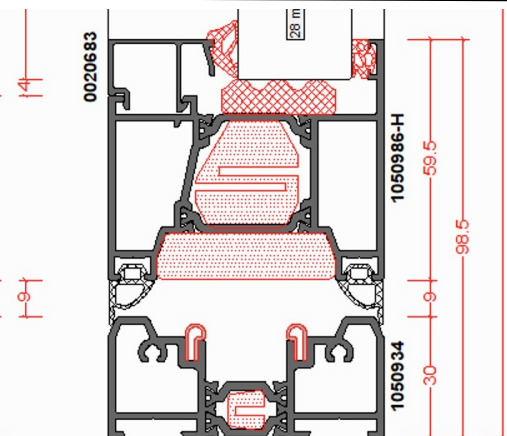

**LEVEL 2**

**THRESHOLD:**

LEVEL 2

LEVEL 3

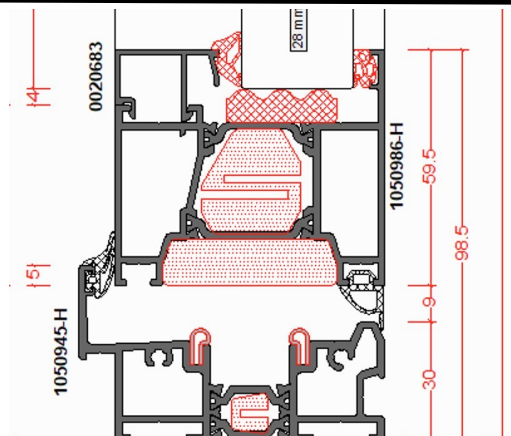

**LEVEL 3**